

(Landowners)

FISHER TWP

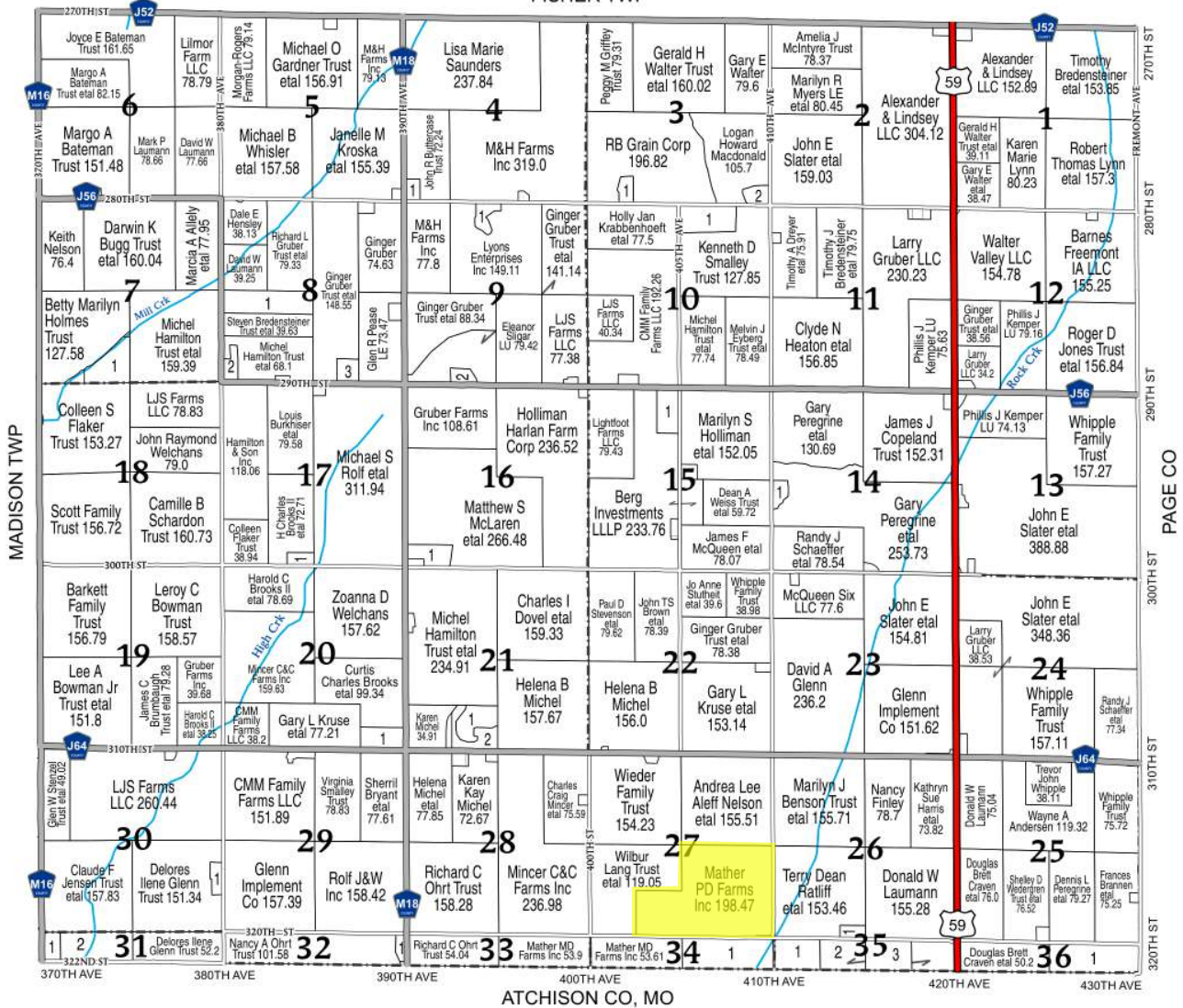

LOCUST GROVE TOWNSHIP

SECTION 3	1 TRANBARGER, REMINGTON ETAL 7.18	2 MOUNT, LARRY DALE ETAL 9.14
SECTION 4	1 DIEHL, LARRY W ETAL 6.07	
SECTION 7	1 LJS FARMS LLC 27.1	
SECTION 8	1 EYBERG TRUST, MELVIN J ETAL 39.61	2 HAMILTON & SON INC 8.43
	3 GRUBER, GARY L ETAL 10.15	

SECTION 9	1 HAYS, DOUGLAS G ETAL 9.41	2 THATCHER, KRISTEN ETAL 7.02
SECTION 10	1 MOUNT, LARRY DALE ETAL 28.15	
SECTION 14	1 MACDONALD, BRAD ETAL 6.74	
SECTION 15	1 VANSYOC, TL ETAL 18.94	
SECTION 16	1 GIBILISCO, SHERRY M 16.66	
SECTION 17	1 VANSYOC, TL ETAL 6.54	

SECTION 20	1 MEAD, BRADLEY J ETAL 18.18	
SECTION 21	1 MICHEL, MICHELE D ETAL 20.26	2 MICHEL, MICHELE ETAL 17.99
SECTION 26	1 FRANK, BRIAN R ETAL 6.29	
SECTION 30	1 GIBILISCO JR, STEVEN LINN ETAL 7.47	
SECTION 31	1 BOTHWELL, TIMOTHY D ETAL 9.71	2 JENSEN TRUST, CLAUDE F ETAL 40.14

SECTION 32	1 ROGERS TRUST, BENNE ETAL 5.11	
SECTION 34	1 BRENDENSTEINER TRUST, STEVEN ETAL 53.59	
SECTION 35	1 HOWELL TRUST, DONNA L 26.5	2 THOMPSON 57 LLC 50.97
	3 ROTHMEYER, DAMIAN 26.51	
SECTION 36	1 WEDERGREN TRUST, SHELLEY D ETAL 48.85	

