

# Soils Map

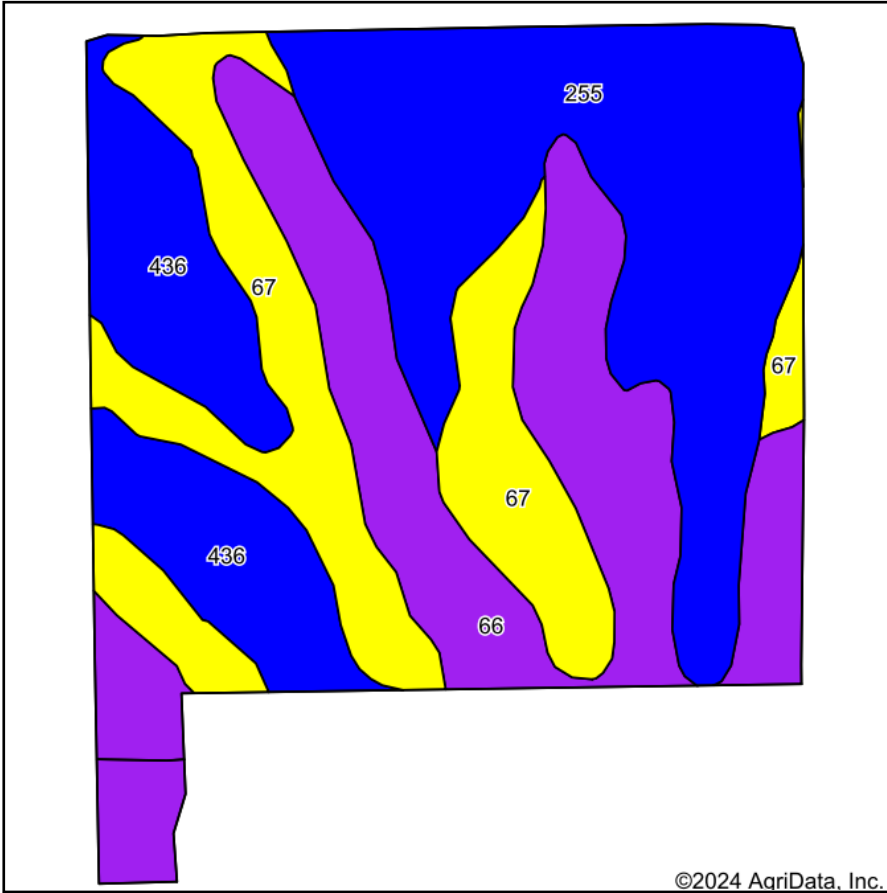

©2024 AgriData, Inc.

Soils data provided by USDA and NRCS.

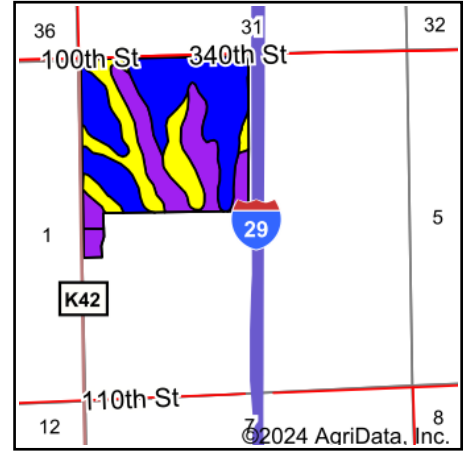

State: **Iowa**  
 County: **Monona**  
 Location: **6-85N-46W**  
 Township: **Lake**  
 Acres: **149.86**  
 Date: **12/26/2024**



Maps Provided By:



© AgriData, Inc. 2023

www.AgriDataInc.com



Area Symbol: IA133, Soil Area Version: 36

Code	Soil Description	Acres	Percent of field	CSR2 Legend	Non-Irr Class *c	CSR2**	CSR	*n NCCPI Overall	*n NCCPI Corn	*n NCCPI Small Grains	*n NCCPI Soybeans	
255	Cooper silty clay loam, 0 to 2 percent slopes, rarely flooded	47.55	31.7%		IIw	85	70	60	60	48	60	
66	Luton silty clay, 0 to 2 percent slopes, rarely flooded	43.29	28.9%		IIIw	57	40	50	41	29	50	
67	Woodbury silty clay, 0 to 2 percent slopes, rarely flooded	34.56	23.1%		IIIw	70	55	53	50	31	53	
436	Lakeport silty clay loam, 0 to 2 percent slopes, rarely flooded	24.46	16.3%		I	88	80	70	67	51	70	
<b>Weighted Average</b>						<b>2.36</b>	<b>73.9</b>	<b>59.5</b>	<b>*n 57.1</b>	<b>*n 53.3</b>	<b>*n 39.1</b>	<b>*n 57.1</b>

\*\*IA has updated the CSR values for each county to CSR2.

\*n: The aggregation method is "Weighted Average using all components"

\*c: Using Capabilities Class Dominant Condition Aggregation Method

Soils data provided by USDA and NRCS.