

(Landowners)
CEDAR TWP

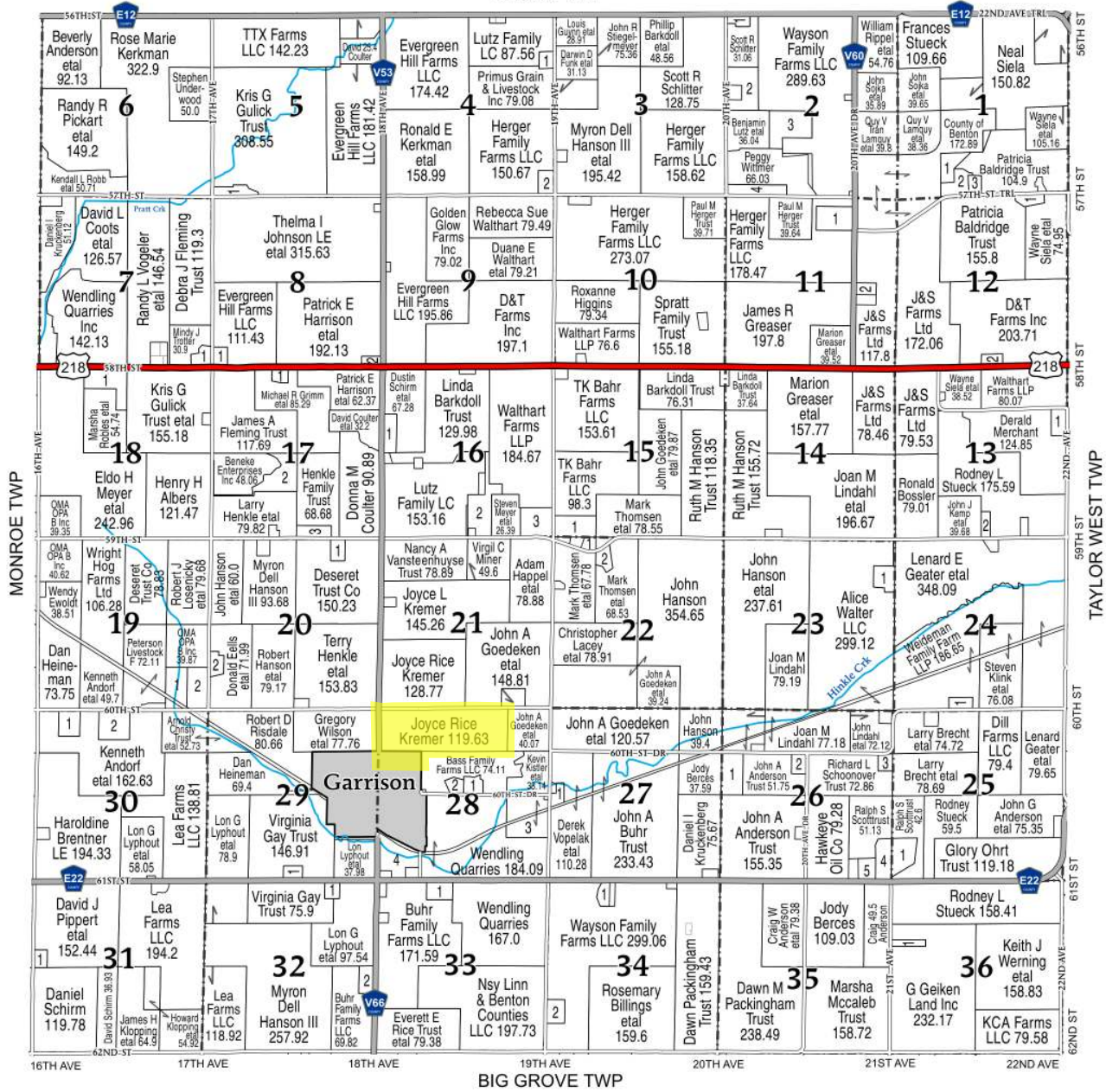

JACKSON TOWNSHIP

SECTION 1	
1 COUNTY OF BENTON	13.28
2 BALDRIDGE, JOSEPH F ETAL	12.32
3 GAINERY JR, WILLIAM J ETAL	5.51
SECTION 2	
1 WOODFORD CREEK FARMS LLP	5.83
2 LUTZ FAMILY LC	24.85
3 WAYSON FAMILY FARMS LLC	28.19
4 WITTMER, ROBERT W ETAL	14.88
SECTION 4	
1 GEIGER, EUGENE	5.69
2 HUTTON, JAMES A ETAL	8.84
SECTION 5	
1 MCDONALD, MICHAEL W	9.58
SECTION 7	
1 DAMRO, JOSEPH ETAL	8.91
SECTION 8	
1 BATHURST DANIEL DUANE	6.75
2 USHER, JERRY L	5.02
SECTION 11	
1 SAUNDERS, MICHAEL P ETAL	19.98
2 KENNEY, JEFFREY L ETAL	5.69

SECTION 12	
1 EDEN, DENNIS R ETAL	6.94
2 JOHNSON TRUST, DICK L	5.84
SECTION 13	
1 KOLOSICK, RICHARD A ETAL	9.44
2 BRESSON, BRANDI	5.29
SECTION 15	
1 WAYSON FAMILY FARMS LLC	19.68
SECTION 16	
1 COULTER, ERIC ETAL	12.06
2 WEISS, HARVEY W ETAL	27.46
3 GARDNER, MAURICE ETAL	21.34
SECTION 17	
1 BALK, JAMES K ETAL	5.24
2 MEYER, STEVEN L ETAL	26.46
3 FLICKINGER, WILLIAM B	9.75
SECTION 18	
1 OLSON, BENJAMIN JOHN	24.88
SECTION 19	
1 WANDO, EMMA L	18.16
2 BENEKE, ANN L	19.78
SECTION 20	
1 LUNDVALL, THOMAS M ETAL	7
2 TEAM DAIRY LLC	7.3

SECTION 22	
1 WAYSON FAMILY FARMS LLC	6.24
2 WIEDITZ, RUTH A	6.99
SECTION 23	
1 HAPPEL, RICKY ALLEN	11.87
SECTION 24	
1 HOFFMAN, ROBIN L	6.44
SECTION 25	
1 SCHRADER, DOUGLAS M	16.81
SECTION 26	
1 BERGES, JODY	19.59
2 FISHER, ANGIE S ETAL	7.06
3 ROBERTS, RAYMOND R ETAL	5.42
4 SCHRADER, DOUGLAS M	14.72
5 RICH, NICHOLAS V ETAL	8.6
SECTION 27	
1 FLICKINGER, LONNY WILLIAM	5.33
SECTION 28	
1 KROUGH, NICHOLAS W ETAL	7.37
2 SMITH, CODY J ETAL	5.69
3 PATTEN, CHARLES ETAL	36.49
4 SCHIRM, DUSTIN L ETAL	26.46
SECTION 29	
1 ZITTERGRUEN, TREVOR M	6.12

SECTION 30	
1 SCHEEL, RANDY H ETAL	12.03
2 HILL, DAVID W ETAL	19.67
SECTION 31	
1 PIPPERT, DAVID ETAL	5.36
SECTION 32	
1 GARRISON CEMETERY	5.88
2 BUHR TRUST, JOHN A ETAL	9.76
SECTION 33	
1 CITY OF GARRISON	10.1
SECTION 34	
1 WALKER, JASON G ETAL	6.06
2 SIMNACHER, DWAYNE A ETAL	9.92
SECTION 36	
1 MILNER, BRYAN E	5.03

