

Aerial Map

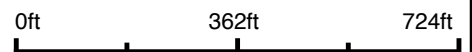

©2022 AgriData, Inc.

Map Center: 42° 15' 21.81, -92° 27' 38.77



15-86N-14W
Tama County
Iowa



9/9/2022



Maps Provided By:



© AgriData, Inc. 2021 www.AgriDataInc.com

Field borders provided by Farm Service Agency as of 5/21/2008.

Soils Map

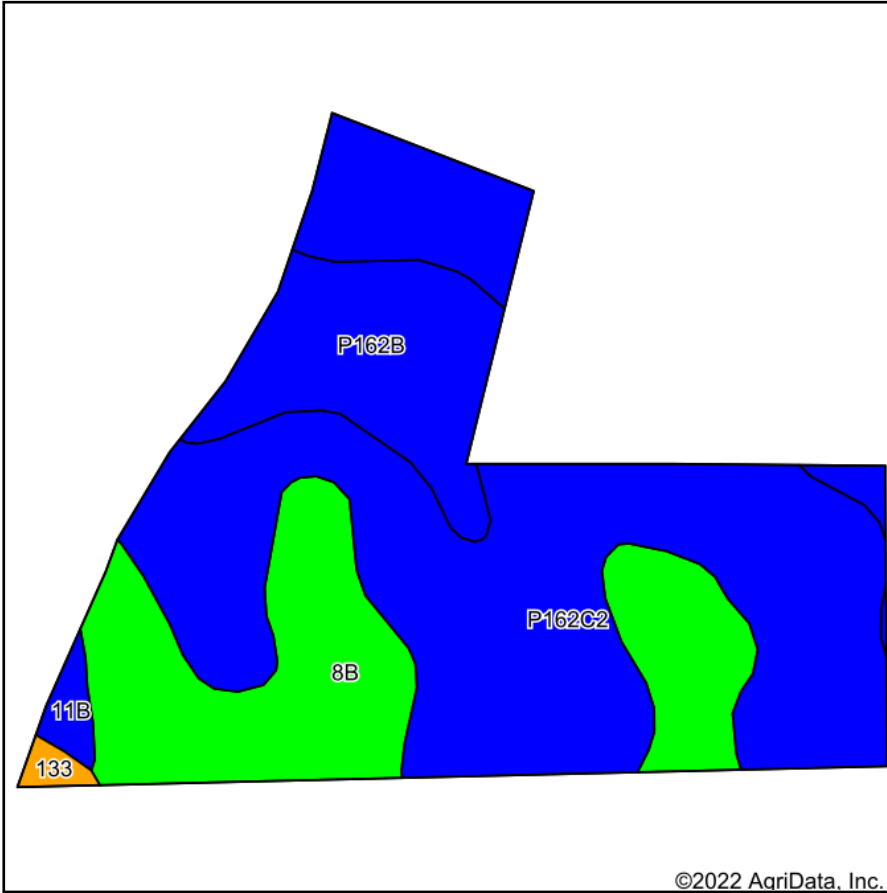

Soils data provided by USDA and NRCS.

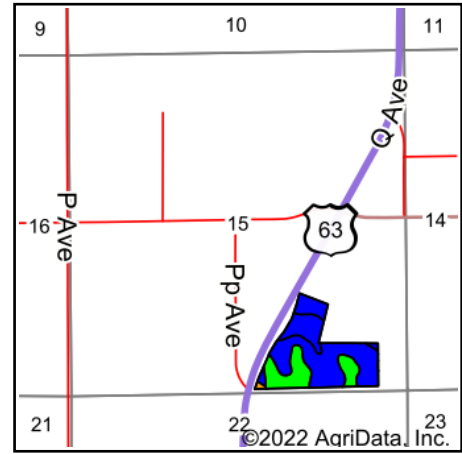

State: **Iowa**
 County: **Tama**
 Location: **15-86N-14W**
 Township: **Buckingham**
 Acres: **36.66**
 Date: **9/9/2022**



Maps Provided By:



© AgriData, Inc. 2021

www.AgriDataInc.com



Area Symbol: IA171, Soil Area Version: 26

Code	Soil Description	Acres	Percent of field	CSR2 Legend	Non-Irr Class *c	*i Corn Bu	*i Soybeans Bu	CSR2**	CSR	*n NCCPI Soybeans	
P162C2	Downs silt loam, paha, 5 to 9 percent slopes, eroded	20.98	57.2%		IVe	0.0	0.0	82		69	
8B	Judson silty clay loam, 2 to 5 percent slopes	9.43	25.7%		Ile	230.4	66.8	93	90	82	
P162B	Downs silt loam, paha, 2 to 5 percent slopes	5.50	15.0%		Ile	0.0	0.0	90		80	
11B	Colo-Ely complex, 0 to 5 percent slopes	0.48	1.3%		IIw	204.8	59.4	86	68	76	
133	Colo silty clay loam, 0 to 2 percent slopes, occasionally flooded	0.27	0.7%		IIw	204.8	59.4	78	85	75	
Weighted Average						3.14	63.5	18.4	86.1	*-	*n 74.1

**IA has updated the CSR values for each county to CSR2.

*- CSR weighted average cannot be calculated on the current soils data, use prior data version for csr values.

*i Yield data provided by the ISPAID Database version 8.1.1 developed by IA State University.

*n: The aggregation method is "Weighted Average using all components"



*c: Using Capabilities Class Dominant Condition Aggregation Method

Soils data provided by USDA and NRCS.

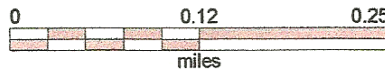
tama cty bham twsp sec 15 sw 1)4
Type



Client: Craig Dinsdale
Farm: Marilyn Dinsdale 101
Field: tama cty bham twsp sec 15 s
Name: Drainage - Completed

	Lateral
	Main
	Sub-Main



Marylin's South • Yield • Avg Yield: 78 bu/ac

• 2021 Soybeans • 38.1 ac

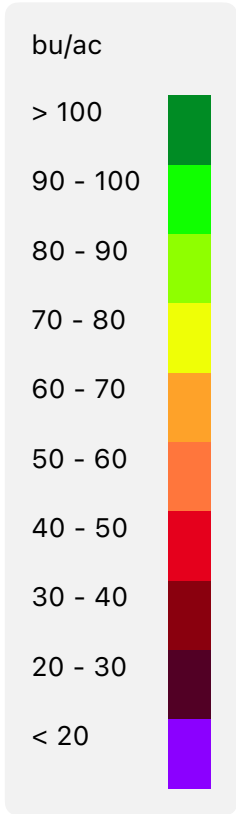
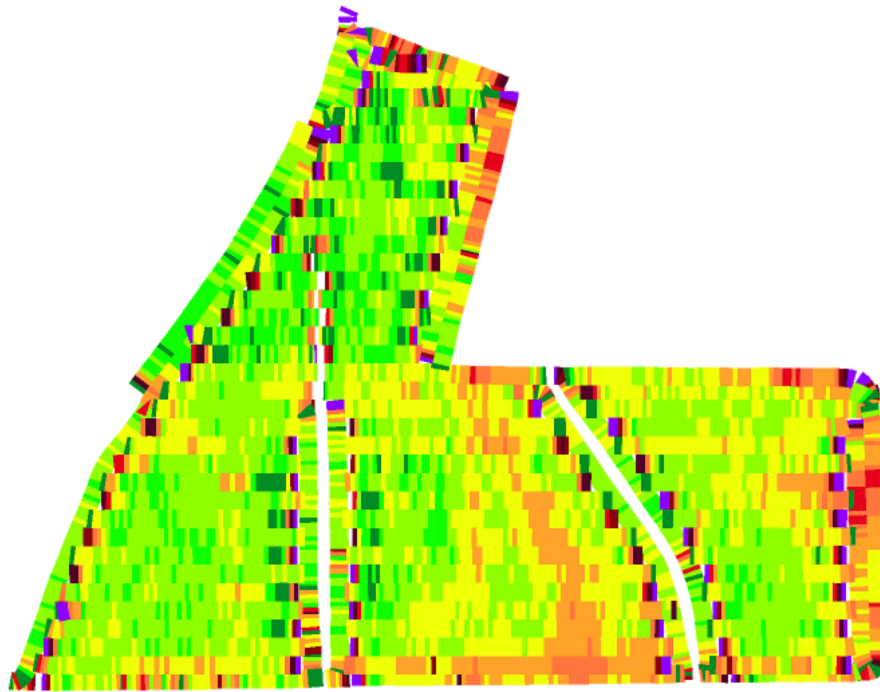

Activity	Date	Avg Amount	Total	Product
Planted	Apr 27, 2021	140,811 seeds/ac	38.0 ac	5028BP08-09-100 3
Harvested	Oct 5, 2021	78 bu/ac 13.7% moisture	36.0 ac	