

# Soils Map

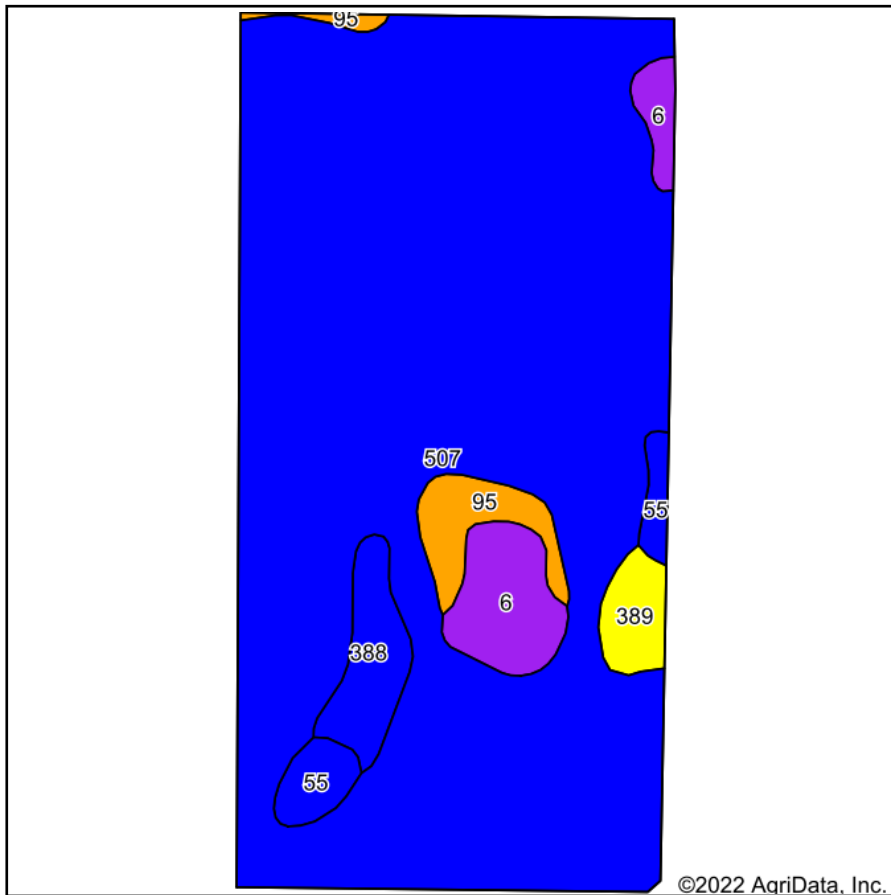

Soils data provided by USDA and NRCS.

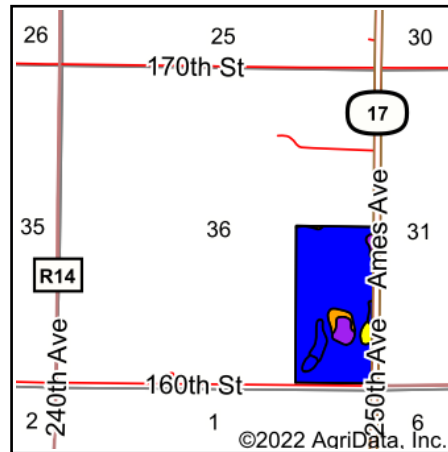

State: **Iowa**  
 County: **Kossuth**  
 Location: **36-95N-27W**  
 Township: **Prairie**  
 Acres: **75.9**  
 Date: **5/31/2022**



Area Symbol: IA109, Soil Area Version: 28

Code	Soil Description	Acres	Percent of field	CSR2 Legend	Non-Irr Class *c	CSR2**	CSR	*n NCCPI Overall	*n NCCPI Corn	*n NCCPI Small Grains	*n NCCPI Soybeans	
507	Canisteo clay loam, 0 to 2 percent slopes	64.72	85.3%		llw	84	75	81	71	56	81	
6	Okoboji silty clay loam, 0 to 1 percent slopes	3.58	4.7%		lllw	59	54	76	74	64	74	
388	Kossuth silty clay loam, 0 to 2 percent slopes	2.37	3.1%		llw	86	75	89	77	60	89	
95	Harps clay loam, 0 to 2 percent slopes	2.17	2.9%		llw	72	60	82	70	54	82	
55	Nicollet clay loam, 1 to 3 percent slopes	1.66	2.2%		lw	89	85	82	81	64	82	
389	Waldorf silty clay loam, 0 to 2 percent slopes	1.40	1.8%		llw	69	66	68	65	58	68	
<b>Weighted Average</b>						<b>2.03</b>	<b>82.4</b>	<b>73.6</b>	<b>*n 80.8</b>	<b>*n 71.4</b>	<b>*n 56.7</b>	<b>*n 80.7</b>

\*\*IA has updated the CSR values for each county to CSR2.

\*n: The aggregation method is "Weighted Average using all components"

\*c: Using Capabilities Class Dominant Condition Aggregation Method

Soils data provided by USDA and NRCS.