

Soils Map

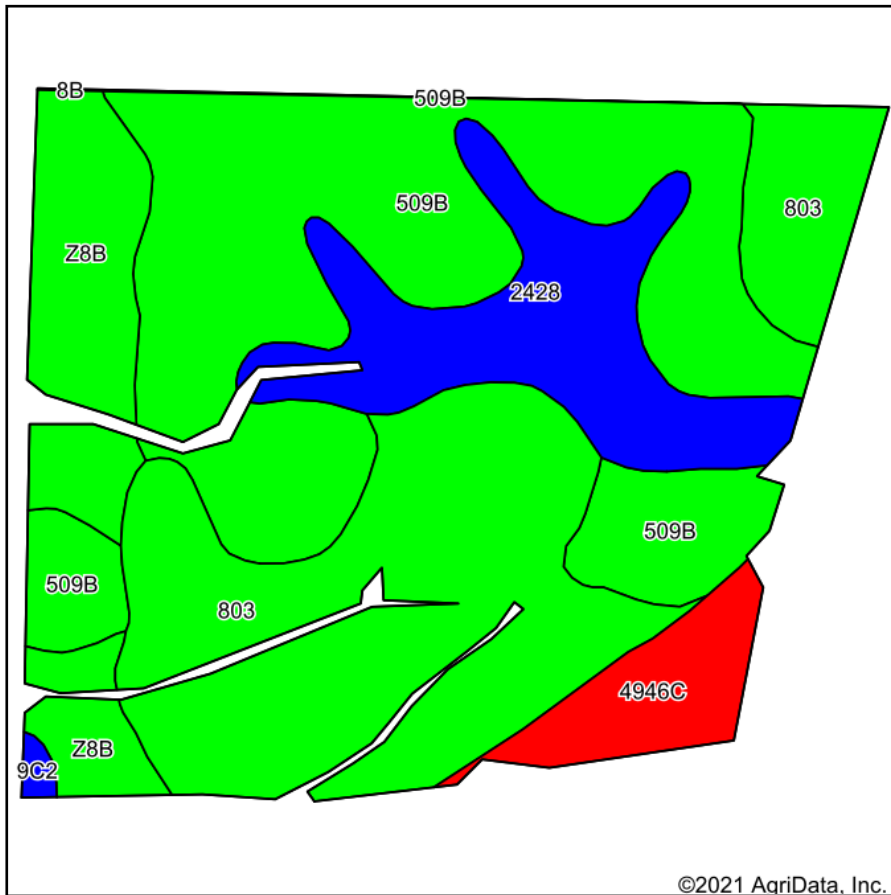

Soils data provided by USDA and NRCS.

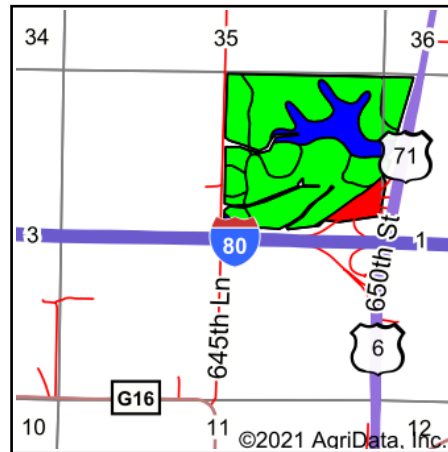

State: **Iowa**
 County: **Cass**
 Location: **2-77N-36W**
 Township: **Pymosa**
 Acres: **150.8**
 Date: **10/27/2021**



Maps Provided By:



© AgriData, Inc. 2021

www.AgriDataInc.com



Area Symbol: IA009, Soil Area Version: 26
 Area Symbol: IA029, Soil Area Version: 28

Code	Soil Description	Acres	Percent of field	CSR2 Legend	Non-Irr Class *c	Irr Class *c	CSR2**	CSR	*n NCCPI Overall	*n NCCPI Corn	*n NCCPI Small Grains	*n NCCPI Soybeans		
509B	Marshall silty clay loam, terrace, 2 to 5 percent slopes	56.57	37.5%		Ile		94	84	96	96	76	82		
803	Melia silty clay loam, terrace, 0 to 2 percent slopes	49.12	32.6%		I	I	100	94	96	96	78	87		
2428	Ely-Colo, overwash-Mt. Sterling complex, 0 to 2 percent slopes	20.26	13.4%		Iw		84	76	88	88	71	79		
Z8B	Judson silty clay loam, deep loess, 2 to 5 percent slopes	16.70	11.1%		Ile		92	83	95	95	71	81		
4946C	Udorthents-Highway complex, 0 to 9 percent slopes	7.49	5.0%				5	0						
9C2	Marshall silty clay loam, 5 to 9 percent slopes, eroded	0.51	0.3%		Ille		87	77	91	91	67	71		
509B	Marshall silty clay loam, terrace, 2 to 5 percent slopes	0.15	0.1%		Ile		94	85	96	96	76	82		
Weighted Average							1.44	0.33	89.9	81.9	*n 90	*n 90	*n 71.6	*n 79

**IA has updated the CSR values for each county to CSR2.

*n: The aggregation method is "Weighted Average using all components"

*c: Using Capabilities Class Dominant Condition Aggregation Method

Soils data provided by USDA and NRCS.